



Ia-ti gasca! Hai sa ne distram in Venus!



Asist. Guta Sebastian  
 Stud. Dublea Adina Elena  
 Stud. Graure Aurelian  
 Stud. Stan Tiberiu  
 Stud. Zaharia Cristina

ORGANIZATOR

PARTENERI



PRIMARIA MUNICIPIULUI MANGALIA SOCIATA ABSOLVENTILOR URBANISTI SI PEISAGIȘTI ALIATI AI UNIVERSITATII DE ARHITECTURA SI URBANISM "ION MINCU" BUCUREȘTI



Chelgate

CHELGATE ROMANIA



CACOMPLEXUL CULTURAL "CALLISTO"

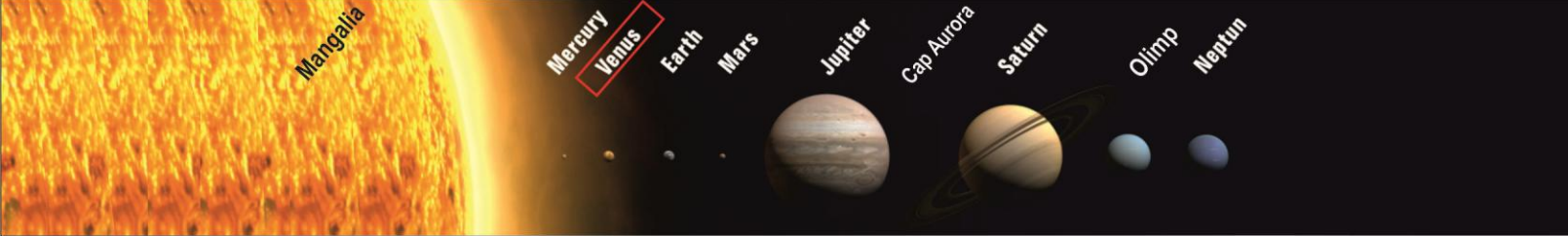

**Venus**  
 Conectivitate | Sistem |  
 Diversitate | Interacțiune | Comunitate

Denumire workshop: DESIGN URBAN SI PEISAGISTIC PE LITORALUL ROMANESC - proiect de propuneri urbanistice si peisagistice  
 Organizator Workshop - Primaria Municipiului Mangalia

## Schema circulatii

### LEGENDA

#### Circulatii carosabile

Principale (sens de mes)

Secundare

#### Circulatii pietonale

Principale

Secundare

De legatura

#### Evenimente

Nod – separare/convergenta

Nod – dispersie

Lipsa orientare/directionare

#### Zone

Zona ce descurajeaza circulatia pietonala prin lipsa amenajarii

## • schema

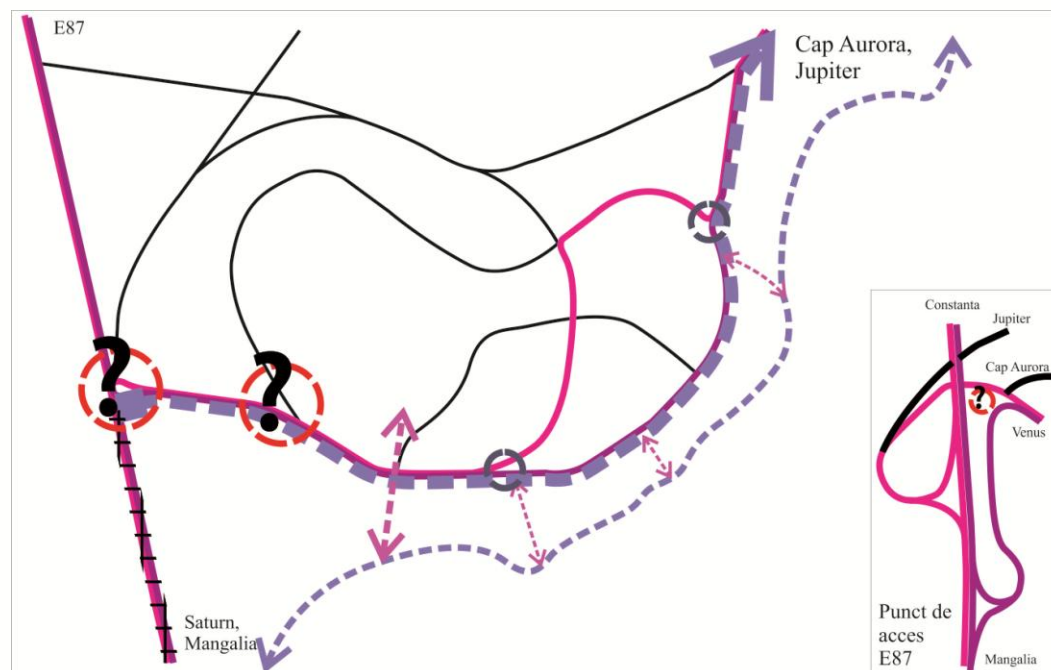

**ANALIZA EXISTENT**

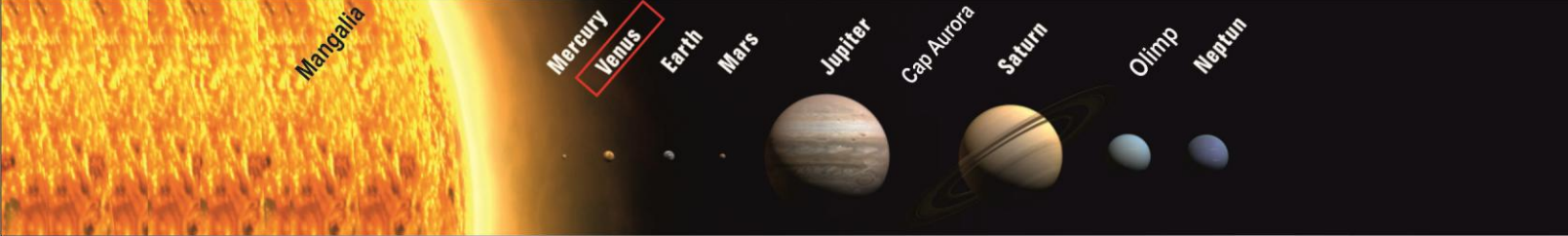

Denumire workshop: DESIGN URBAN SI PEISAGISTIC PE LITORALUL ROMANESC - proiect de propuneri urbanistice si peisagistice  
 Organizator Workshop - Primaria Municipiului Mangalia

## Schema spatii verzi

### LEGENDA

#### Vegetatie

- Foioase
- Rasionase

#### Aliniamente

- Ordonate – foioase
- Ordonate – rasinoase
- Rezultate – mixte
- Joase – gard viu

#### Evenimente

- Repere

#### Zone

- Zona degrata de vegetatia spontana
- Zona vegetatie joasa
- Zone amenajate – fara caracter

## • schema



**ANALIZA EXISTENT**

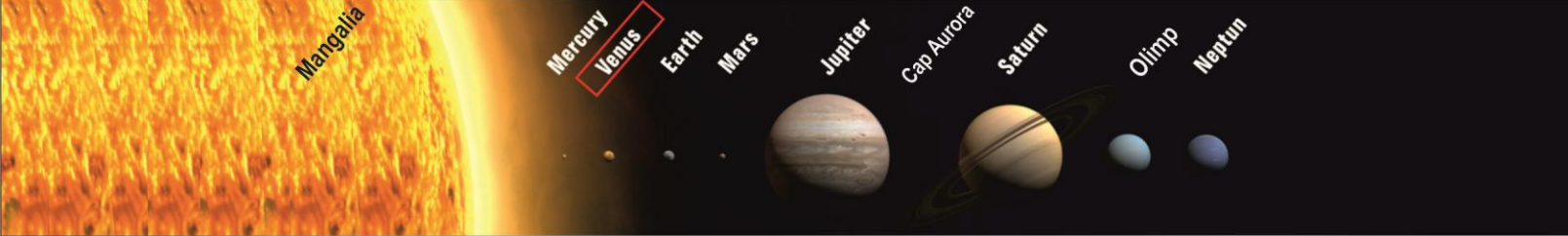

Venus  
 Conectivitate | Sistem |  
 Diversitate | Interactiune | Comunitate

Denumire workshop: DESIGN URBAN SI PEISAGISTIC PE LITORALUL ROMANESC - proiect de propuneri urbanistice si peisagistice  
 Organizator Workshop - Primaria Municipiului Mangalia

## Sinteza analizei

### LEGENDA

- Circulatii principale (sens)
- Circulatii secundare
- Circulatie principala pietonala
- Circulatie pietonala secundara
- Nod rutier important
- Grup mixt vegetatie
- Foioase, rasinoase aliniament
- Vegetatie spontana
- Lipsa amenajare peisagera
- Zona construita degradata
- Zona cu potential
- Element de capat
- Element de legatura
- Elemente nevalorificate
- Lipsa directionalitate
- Relatie valoroasa

## • schema



**ANALIZA EXISTENT**

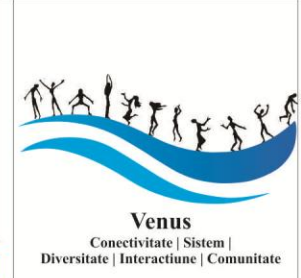
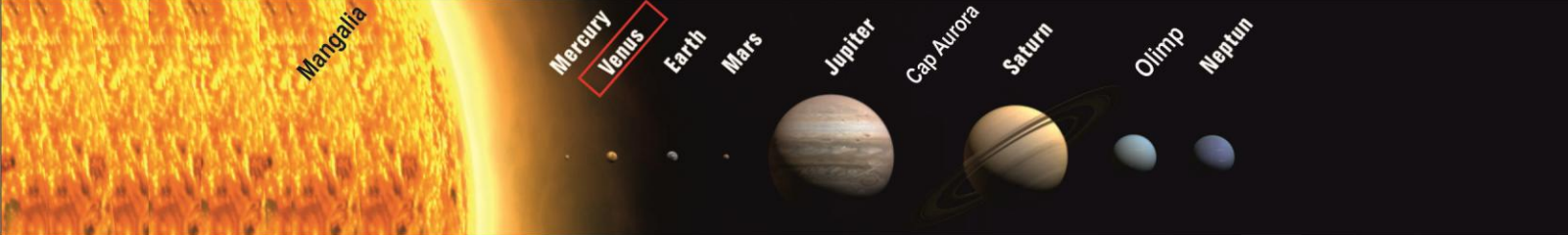

Denumire workshop: DESIGN URBAN SI PEISAGISTIC PE LITORALUL ROMANESC - proiect de propuneri urbanistice si peisagistice

Organizator Workshop - Primaria Municipiului Mangalia

## Imagini comentate



**Zonele de intrare in statiunea Venus.** Rezolvarea actuala a acestor spatii pare rezultata in urma lucrarilor de infrastructura executate, si nu in urma unei analize spatial configurative. Ele pot decide dorinta trecatorilor in legatura cu vizitarea acestei statiuni.

## Imagini comentate



**Zonele de intrare in statiunea Venus.** Obiectul semnal din prezent actioneaza ca un accent vertical. Acesta trebuie sa isi pastreze inaltimea considerabila, pentru a putea fi observat de fluxul de circulatie de pe artera suspendata.

**ANALIZA EXISTENT**

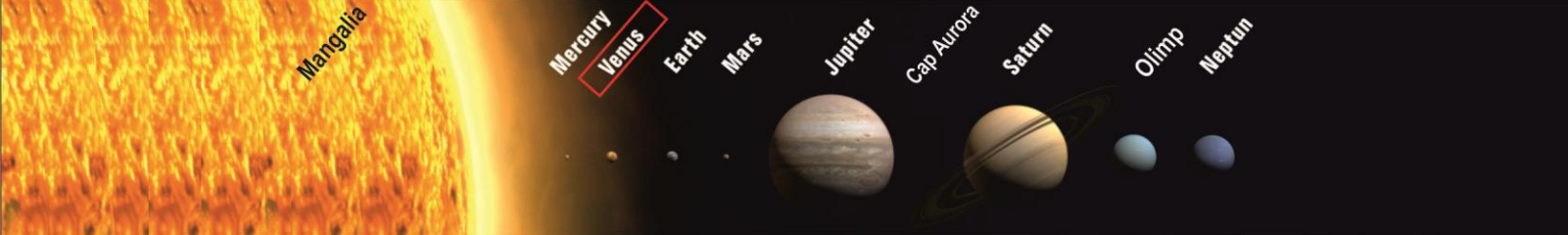

**Venus**  
Conectivitate | Sistem |  
Diversitate | Interactiune | Comunitate

Denumire workshop: DESIGN URBAN SI PEISAGISTIC PE LITORALUL ROMANESC - proiect de propuneri urbanistice si peisagistice

Organizator Workshop - Primaria Municipiului Mangalia

## Imagini comentate



**Statiunea Venus.** Se poate observa necesitatea unor accente volumetrice, vegetale pentru a valorifica aceasta zona de intrare, cat si pentru a oferi un sens de protejare al traseului carosabil. De asemenea plasarea unor indicatoare in aditia obiectului semnal ar fi favorabila.

## Imagini comentate



**Statiunea Venus.** Sunt prezente probleme la nivel de trama stradala, zona pietonala. Lipseste uniformitatea, Nu exista un standard de construire sau norme referitoare restrictiilor in acest sens. Se pot observa diferente de nivel, cat si contraste stridente de texturi diferite, cromatica.

**ANALIZA EXISTENT**

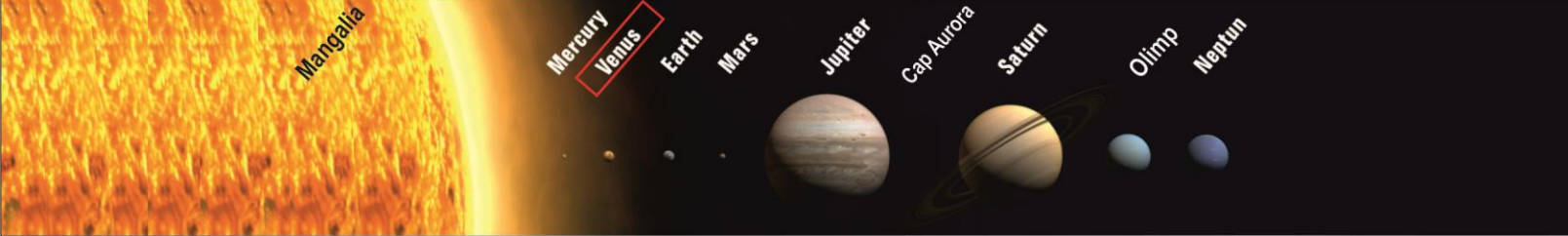

Venus  
 Conectivitate | Sistem |  
 Diversitate | Interactiune | Comunitate

Denumire workshop: DESIGN URBAN SI PEISAGISTIC PE LITORALUL ROMANESC - proiect de propuneri urbanistice si peisagistice

Organizator Workshop - Primaria Municipiului Mangalia

## Etape de interventie

### LEGENDA

- Traseu pietonal si carosabil principal in interiorul statiunii
- Traseu pietonal pe plaja
- Scuar de distributie a circulatiei reamenajat (vegetal)
- Piateta, zona de bazar
- Scuar reamenajat (mineral)
- Vegetatie de aliniament
- Obiect semnal
- Statuia Venus
- Acces principal catre plaja
- Acces secundar catre plaja

## • Strategie de interventie pe statiune

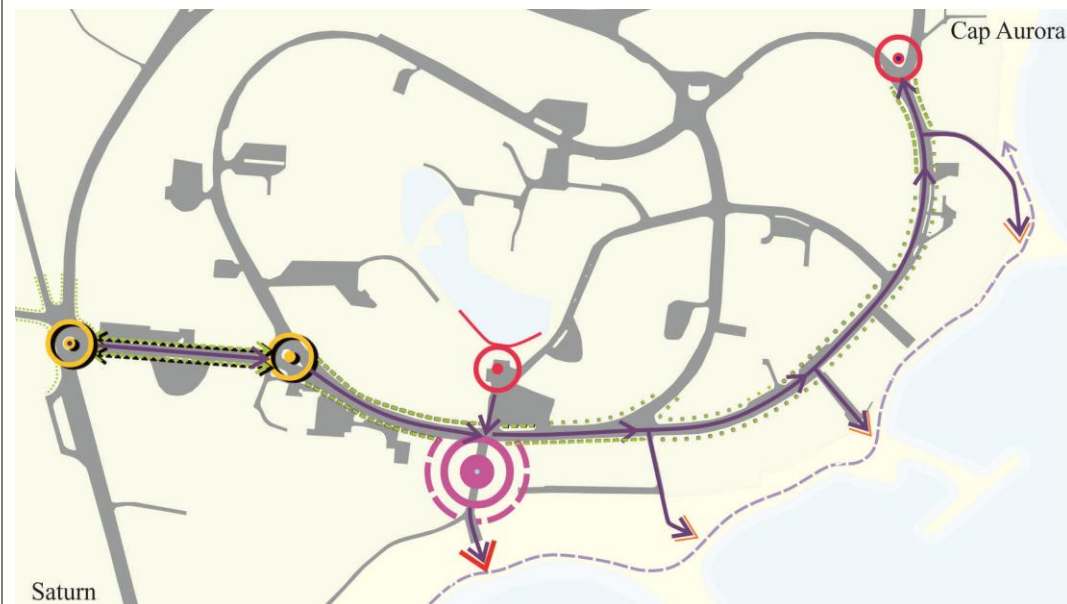

**PROPUNERE**

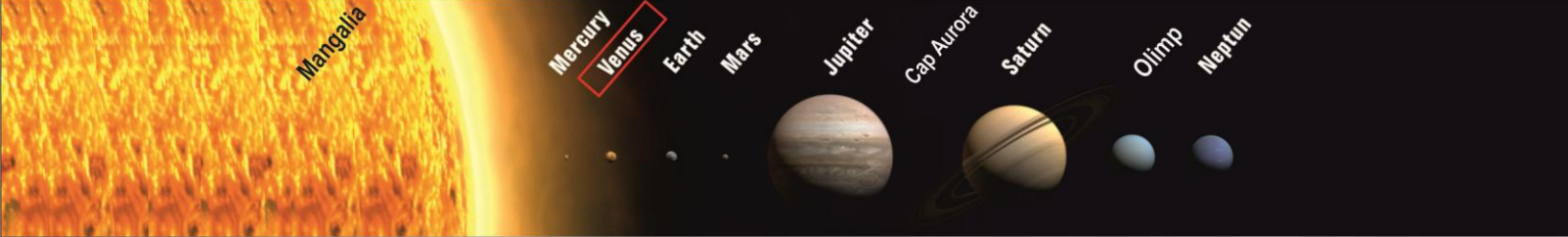

**Venus**  
 Conectivitate | Sistem |  
 Diversitate | Interactiune | Comunitate

Denumire workshop: DESIGN URBAN SI PEISAGISTIC PE LITORALUL ROMANESC - proiect de propuneri urbanistice si peisagistice  
 Organizator Workshop - Primaria Municipiului Mangalia

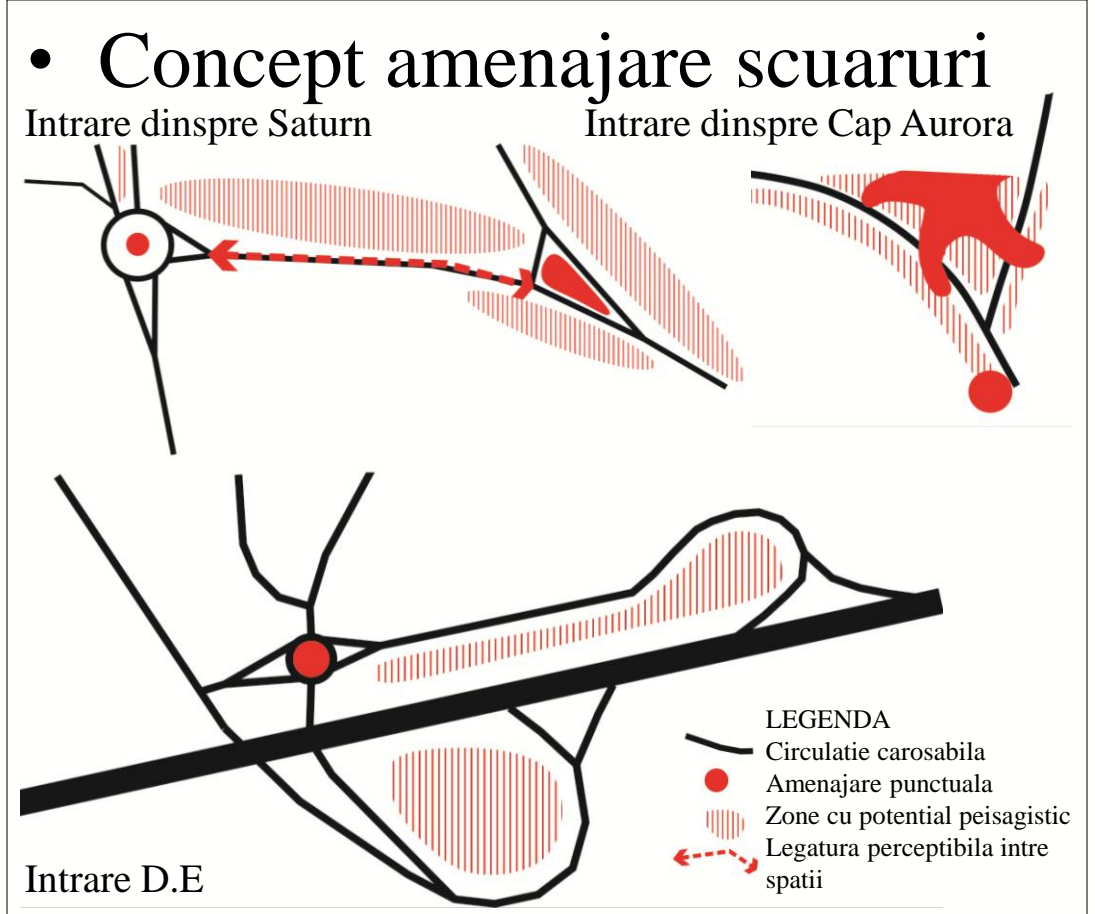
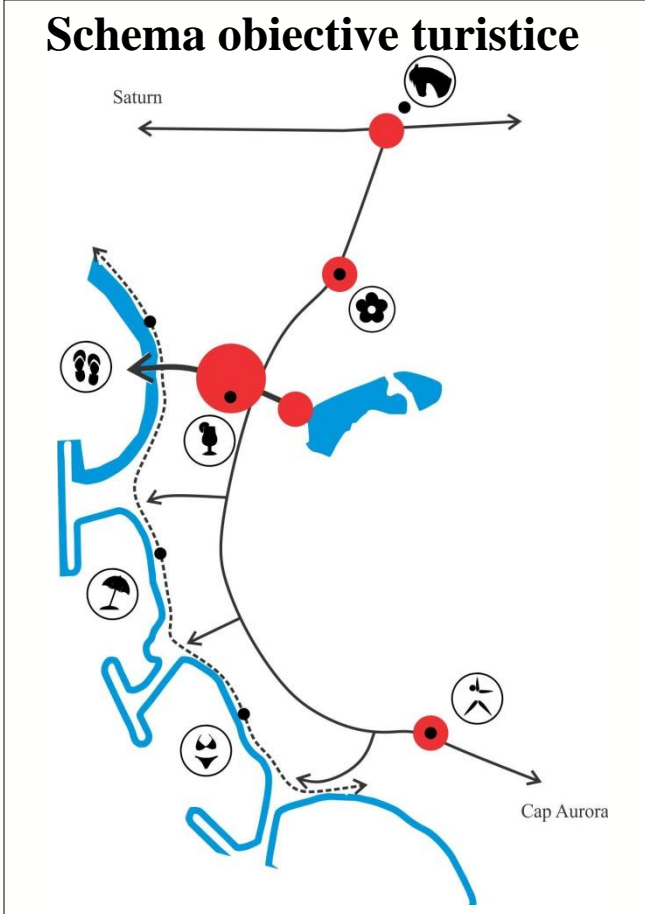

**PROPUNERE**



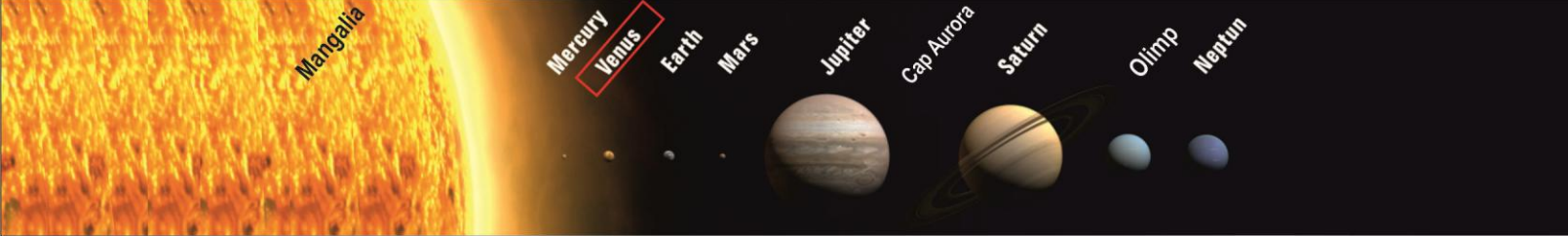

**Venus**  
 Conectivitate | Sistem |  
 Diversitate | Interactiune | Comunitate

Denumire workshop: DESIGN URBAN SI PEISAGISTIC PE LITORALUL ROMANESC - proiect de propuneri urbanistice si peisagistice  
 Organizator Workshop - Primaria Municipiului Mangalia

# • Plan existent

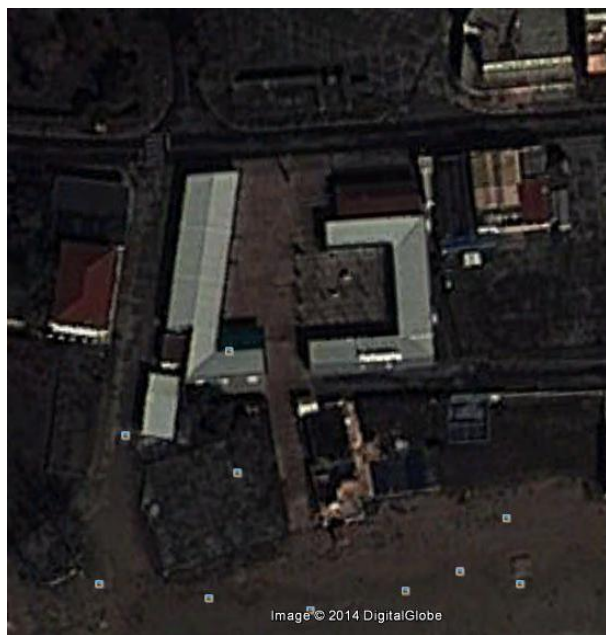

# • Plan propunere

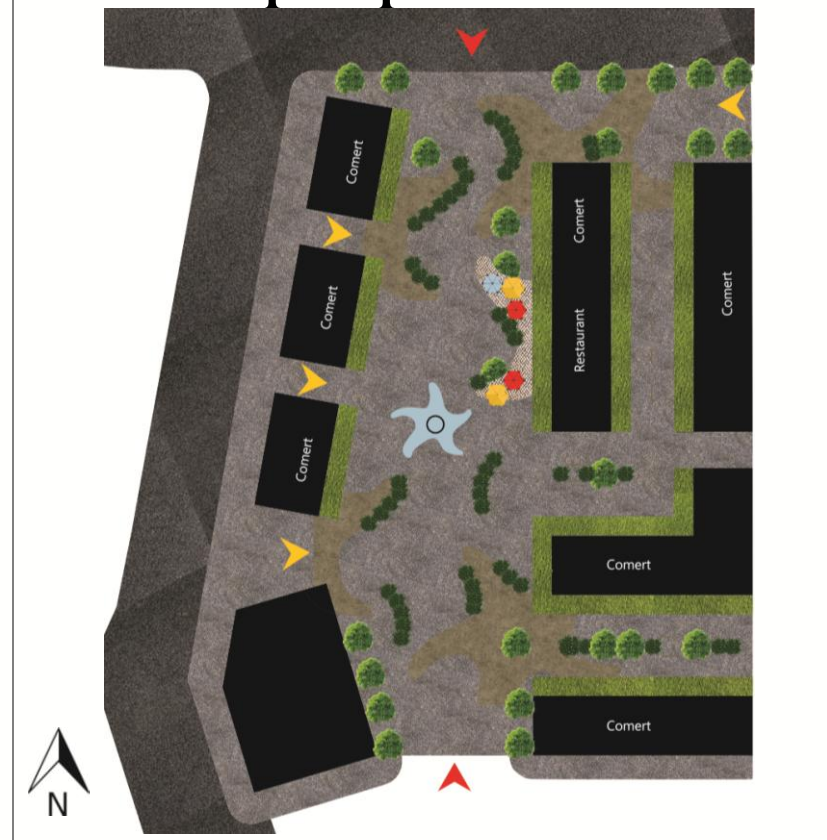

## LEGENDA

- |  |                 |  |                |  |         |
|--|-----------------|--|----------------|--|---------|
|  | Carosabil       |  | Acces secundar |  | Arbusti |
|  | Pietonal        |  | Pavaj          |  | Umbrele |
|  | Acces principal |  | Dec lemn       |  | Banci   |
|  |                 |  | Pergole        |  | Venus   |
|  |                 |  | Arbori         |  |         |

**PROPUNERE**

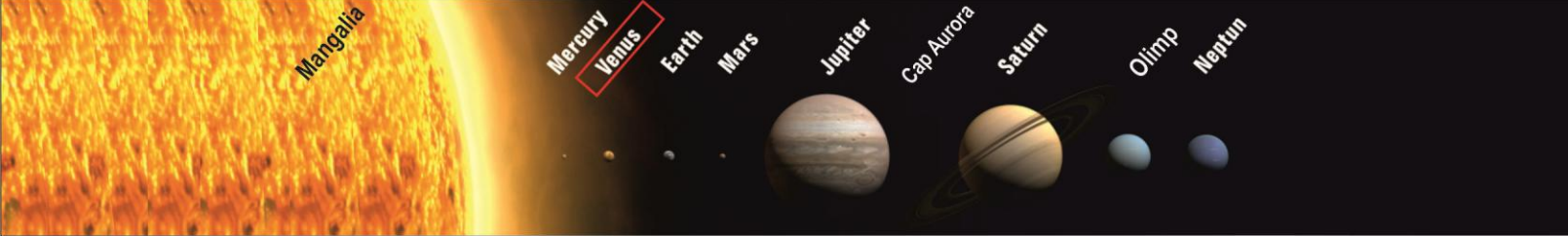

Denumire workshop: DESIGN URBAN SI PEISAGISTIC PE LITORALUL ROMANESC - proiect de propuneri urbanistice si peisagistice  
 Organizator Workshop - Primaria Municipiului Mangalia

## Img existent



## Img propus



**PROPUNERE**

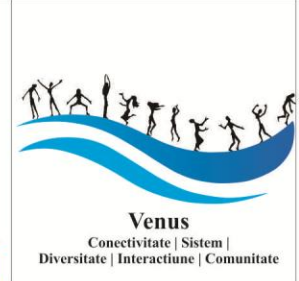
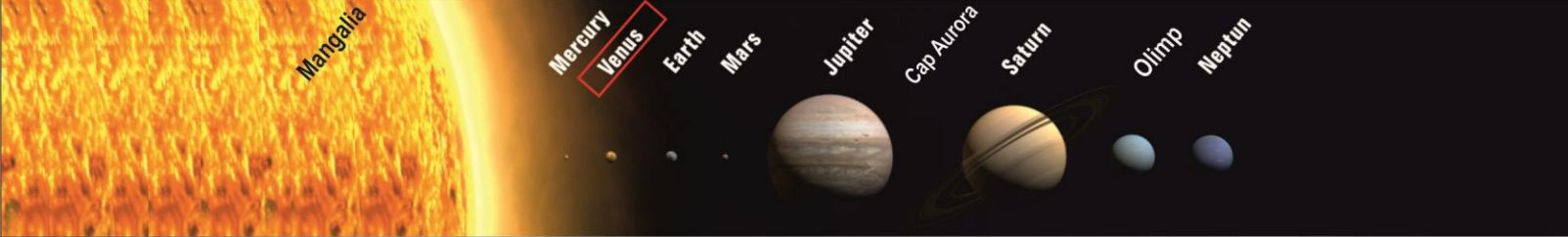

Denumire workshop: DESIGN URBAN SI PEISAGISTIC PE LITORALUL ROMANESC - proiect de propuneri urbanistice si peisagistice  
 Organizator Workshop - Primaria Municipiului Mangalia

## Obiect semnal intrare comuna Venus si Saturn

## Obiect semnal pieteta - Venus

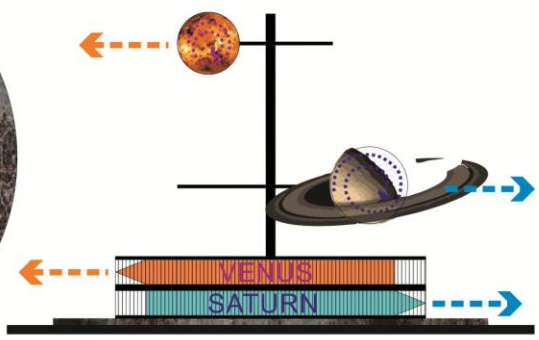
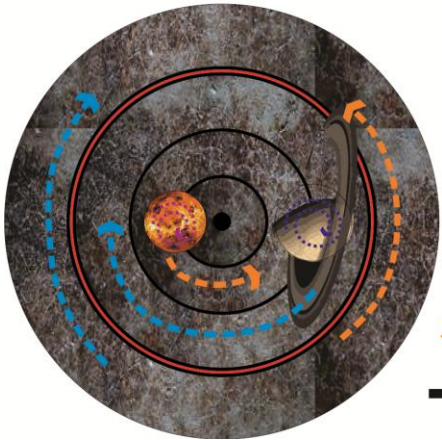

Amenajare acces plaja

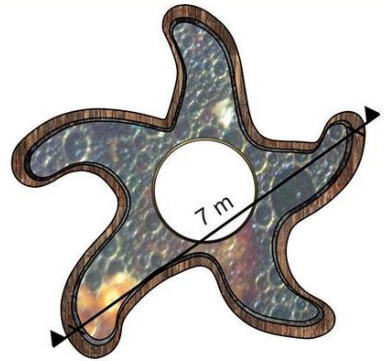

Sectiune fantana

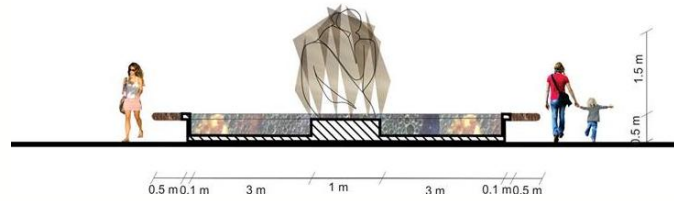
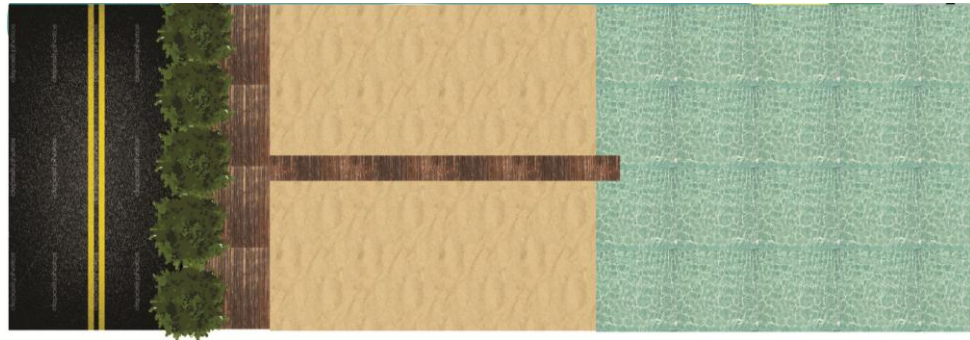

**PROPUNERE**

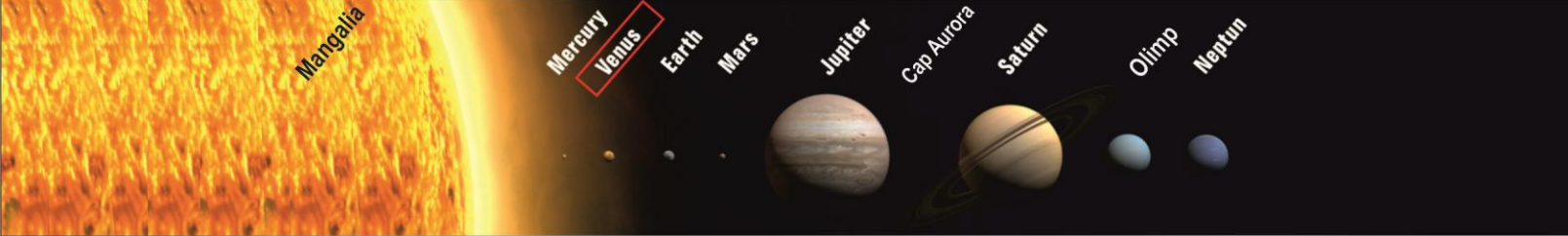

Denumire workshop: DESIGN URBAN SI PEISAGISTIC PE LITORALUL ROMANESC - proiect de propuneri urbanistice si peisagistice  
 Organizator Workshop - Primaria Municipiului Mangalia

- Plan existent
- Google

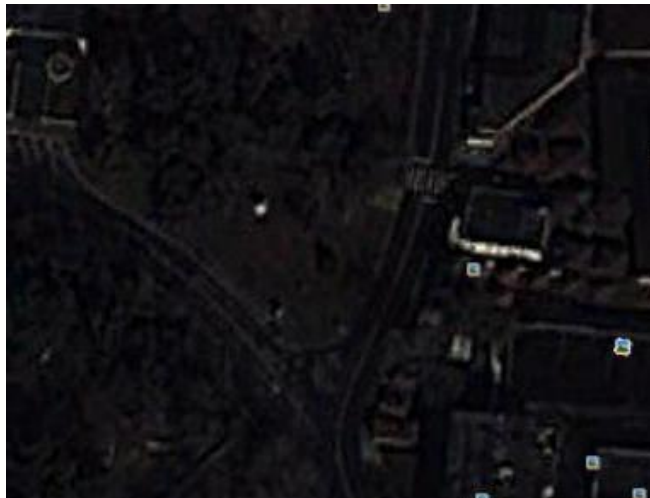

- Plan propunere

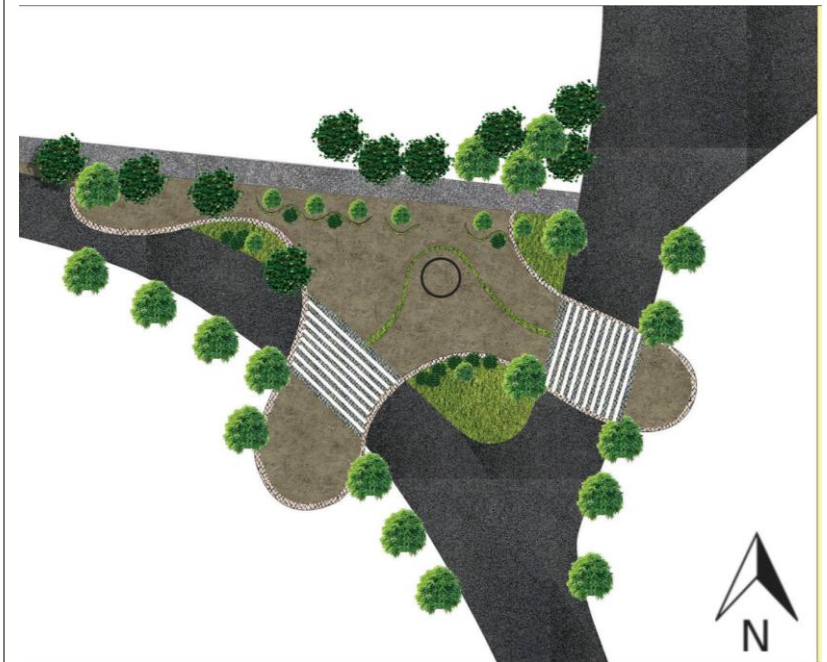

LEGENDA

	Carosabil		Pavaj legatura		Arbusti
	Pietonal		Gazon		Banci
	Pavaj		Arbori		Venus

**PROPUNERE**

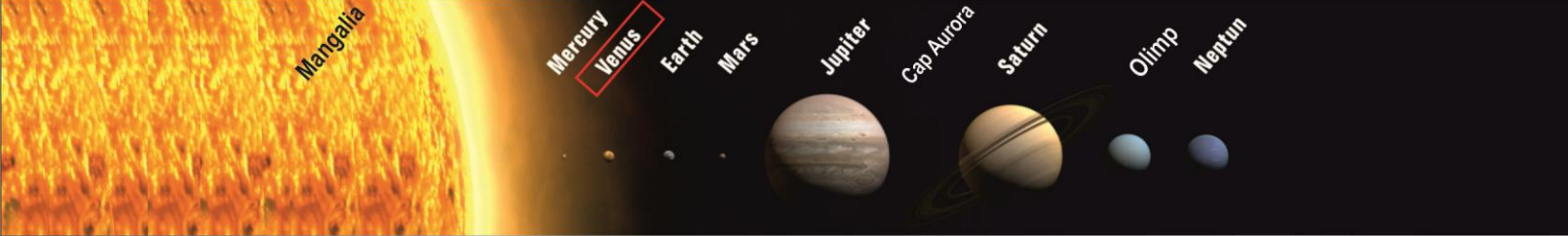

Denumire workshop: DESIGN URBAN SI PEISAGISTIC PE LITORALUL ROMANESC - proiect de propuneri urbanistice si peisagistice  
Organizator Workshop - Primaria Municipiului Mangalia

## Img existent



## Img propus



**PROPUNERE**

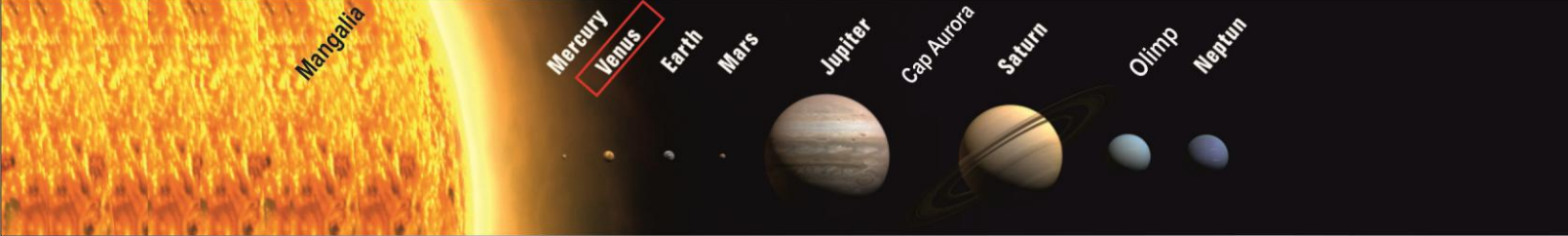

Denumire workshop: DESIGN URBAN SI PEISAGISTIC PE LITORALUL ROMANESC - proiect de propuneri urbanistice si peisagistice  
 Organizator Workshop - Primaria Municipiului Mangalia

Obiect semnal intrare dinspre Cap Aurora

Obiect semnal intrare din Drumul European

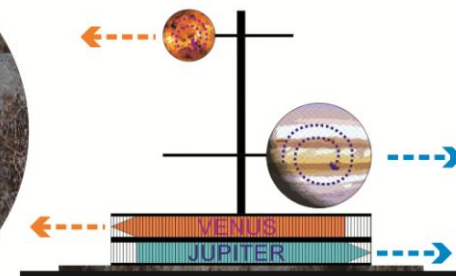
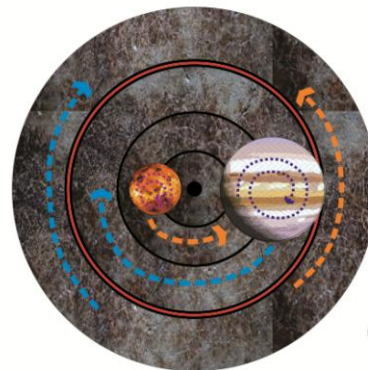
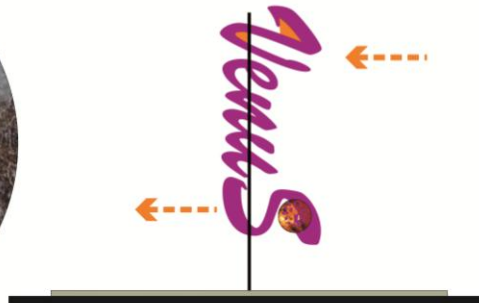
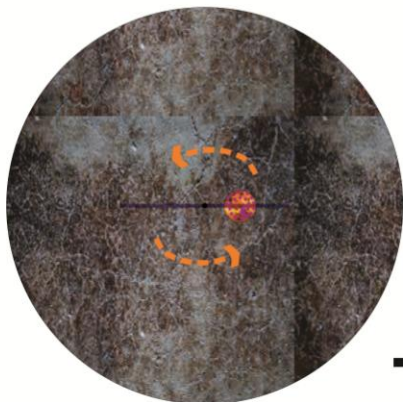

**Img. prop.** intrare principala statiunea Venus



**PROPUNERE**

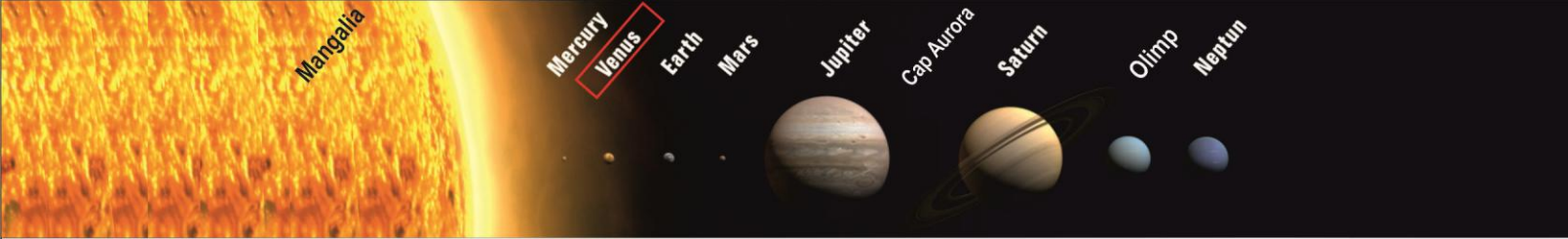

Denumire workshop: DESIGN URBAN SI PEISAGISTIC PE LITORALUL ROMANESC - proiect de propuneri urbanistice si peisagistice  
Organizator Workshop - Primaria Municipiului Mangalia

# Te-am convins? Ia-ti gasca! Hai sa ne distram in Venus!



ORGANIZATOR



PRIMARIA MUNICIPIULUI MANGALIA

PARTENERI



ASOCIATIA ABSOLVENTILOR URBANISTI SI PEISAGISTI DIN ROMANIA  
UNIVERSITATEA DE ARHITECTURA SI URBANISM 'ION MINCU' BUCURESTI



CHELGATE ROMANIA



CAZARILE CALATIS  
COMPLEXUL CULTURAL 'CALLATIS'